

# Grid 15

Manual

Created by

Smartbox

This guide provides the basics for getting started with your Grid Pad.

You can find a complete guide to all the features of your Grid Pad on the Smartbox Hub:



[hub.thinksmartbox.com/gridpad15](https://hub.thinksmartbox.com/gridpad15)

# Smartbox

Document: Grid Pad 15 - Manual - UK - D  
Language: English  
Date of issue: October 2022

Copyright © 2022 Smartbox Assistive Technology

# Grid Pad 15

## Manual

1.	Starting Grid 3	4
2.	Features	6
3.	Power	10
4.	Remote power button	12
5.	Charging	13
6.	Mounting	14

1

## Starting Grid 3

Grid 3 will automatically start when the device is switched on by default, however you can start Grid 3 from the desktop from the Grid 3 icon on the desktop.



For more resources and guides on how to get started with Grid visit the Smartbox Hub.

- Get started with Grid
- Access methods and setup
- Troubleshooting guides
- Videos and webinars
- Resources for grid sets
- ...and much more.



[hub.thinksmartbox.com/grid3](https://hub.thinksmartbox.com/grid3)

# 2

## Features

### Grid Pad 15

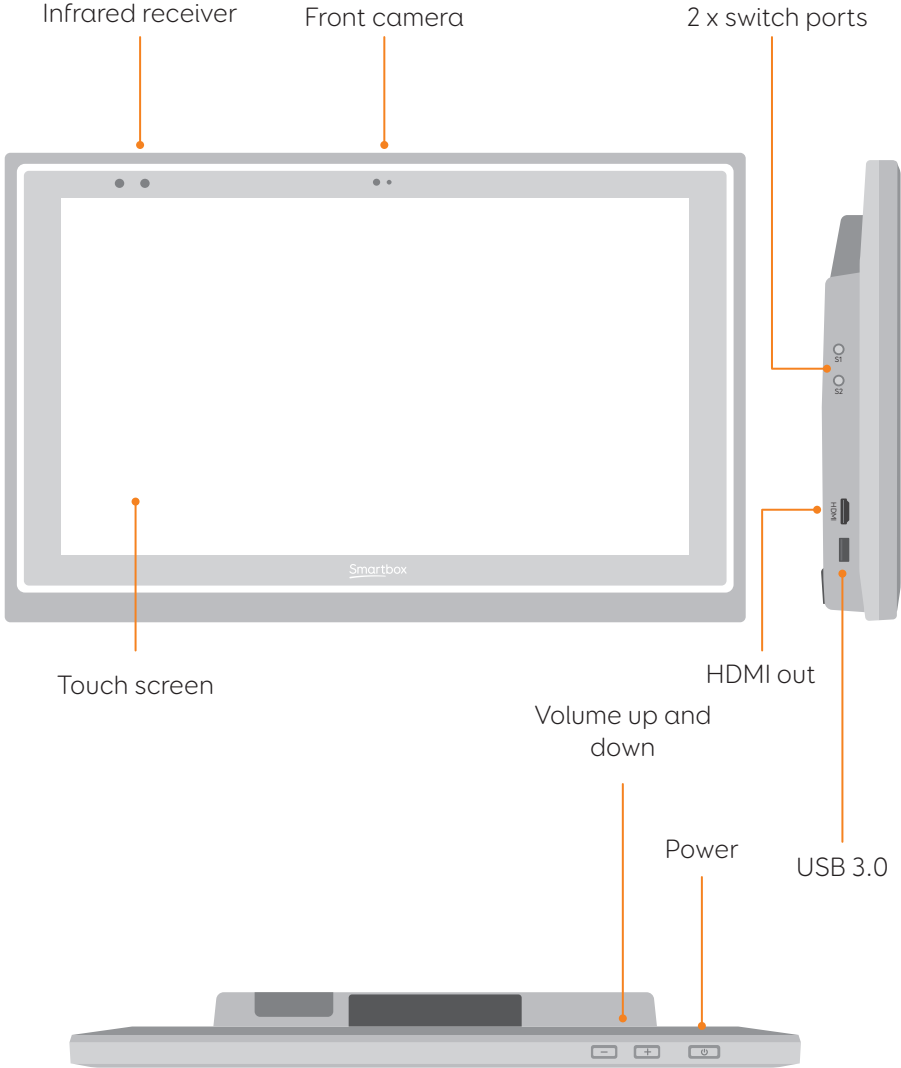

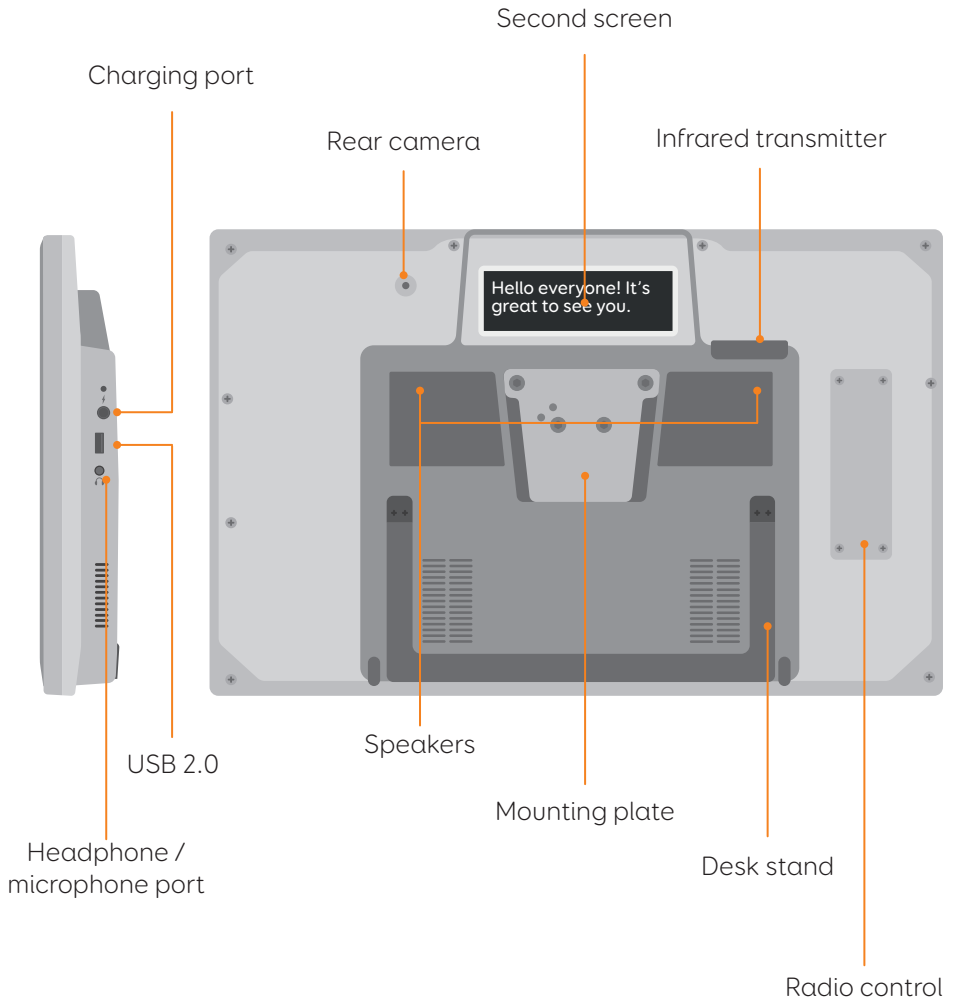

## Grid Pad 15 with eye gaze unit

When the Grid Pad is supplied with an eye gaze unit, it comes with a longer desk stand to accommodate the camera.

The USB 3.0 socket will be used for the camera connection.



Eye gaze camera



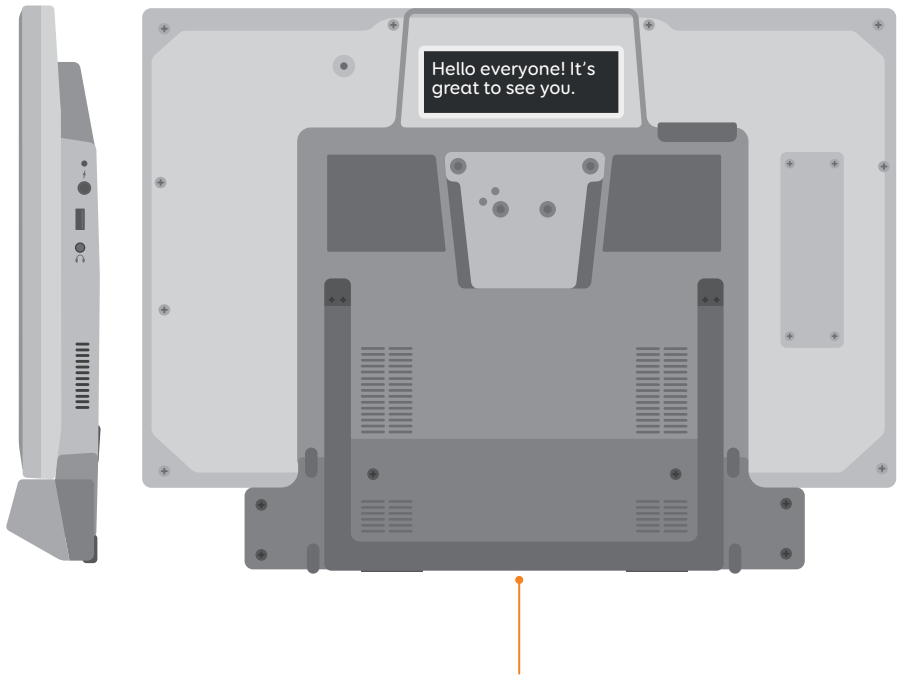

Elongated desk  
stand

# 3

## Power

Before switching on your Grid Pad for the first time, it is best to plug in the power lead and charge the battery. Press the power to turn the device on, the LED will light up to signal the device is starting.



Your Grid Pad will automatically load Grid 3 when turned on.

## Shutting down your Grid Pad

When not in use, it is good practice to shut down your Grid Pad completely. This will give any automatic updates a chance to be applied. We also recommend that your device is shut down before it is stored for transit.

Open the Start menu and tap the power icon. From here you can select Sleep, Shut down and Restart. Selecting Shut down will power the device down completely.

It is also possible to turn off your device from within Grid 3, by using the Turn off computer command. This command can be added to any grid set.

### Force shut down

If you press and hold the power button for five seconds, your Grid Pad will shut down. Please note that this is only recommended in emergencies, and that any unsaved work will be lost.

# 4

## Remote power button

Your Grid Pad comes supplied with a remote power button. This is designed to enable anyone to turn on their device either using the built in button or a separate switch.

### Setup

The remote power button will already be paired with your Grid Pad. To use the remote power button, remove the battery cover on the back and insert two AAA batteries. If you do not intend on using the remote power button, or need to store it for a long period, we recommend that you remove the batteries.

### Using the remote power button

Press the power button once to turn your Grid Pad on or wake it from sleep.

In the event of a crash, press and hold the button for 5 seconds to force the Grid Pad to shut down. Note you may lose work and unsaved changes!

### Attaching an additional switch

The remote power button has a built in 3.5mm jack. You can use this to attach a compatible switch to turn your Grid Pad on. When a switch is attached, it will act exactly like the button.

# Charging

To charge your Grid Pad, plug the power lead into the charging port on the left side of the device.

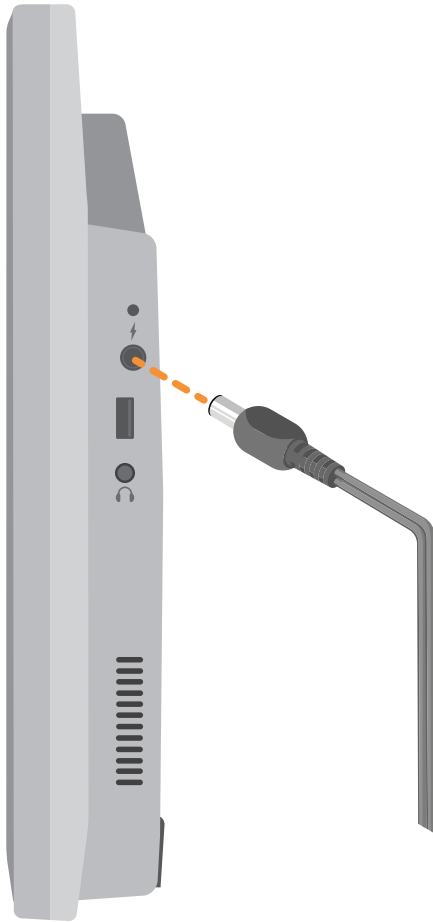

# 6

## Mounting

### Adjustable stand

Your Grid Pad has an adjustable stand that can be folded out, to position your device on a desk or table comfortably.

Pull the stand from the bottom and adjust the angle to suit you. When finished, simply push the stand back in.



### Using a desk, floor, or wheelchair mount

Your Grid Pad is supplied with a mounting plate for both Rehadapt and Daessy, so that you can securely mount and position your device.

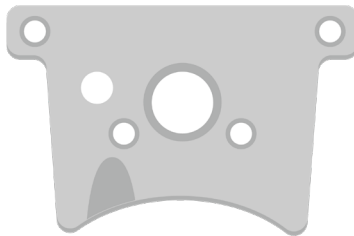

Mounting plate

---

---

---

---

---

---

---

---

---

---

---

---

---

---

---

---

---

---

---

---

---

---

---

# Grid **Pad** 15



[hub.thinksmartbox.com/gridpad15](https://hub.thinksmartbox.com/gridpad15)

**Smartbox**  
thinksmartbox.com